

FRAMING PLAN NOTES

- REF S1.2 FOR SCHEDULES.
- REF DETAIL 8 REFERS TO THE DETAIL ON THE WOOD FRAMING DETAIL SHEETS.
- VERIFY ALL DIMENSIONS, DROPS, SLOPES, ETC WITH ARCH PRIOR TO CONSTRUCTION.
- ALL ELEVATIONS ARE RELATIVE TO TOP OF CONC AT 1ST FLOOR = 100'-0".
- TRUSS MFR SHALL DESIGN TRUSSES FOR DRAG LOAD OF 3.0 KIPS WHERE INDICATED.
- SPACE TRUSSES TO PROVIDE CLEARANCE ABOVE MECHANICAL AREAS. COORD W/ MEP.
- PROVIDE MIN WOOD HDRS IN ALL BEARING AND EXTERIOR WALLS PER NOTES 1 & 2 IN WOOD BEAM SCHEDULE ON S1.2.
- INCREASE TRUSS HEEL TO ACCOMMODATE ARCHITECTURAL PLATE HEIGHT WHERE APPLICABLE.
- GIRDER TRUSSES AT FLOOR FRAMING SHALL BE 3" DEEP UNO.

TOC ELEVATIONS

LEVEL 2	112'-9"
LEVEL 1	100'-0"

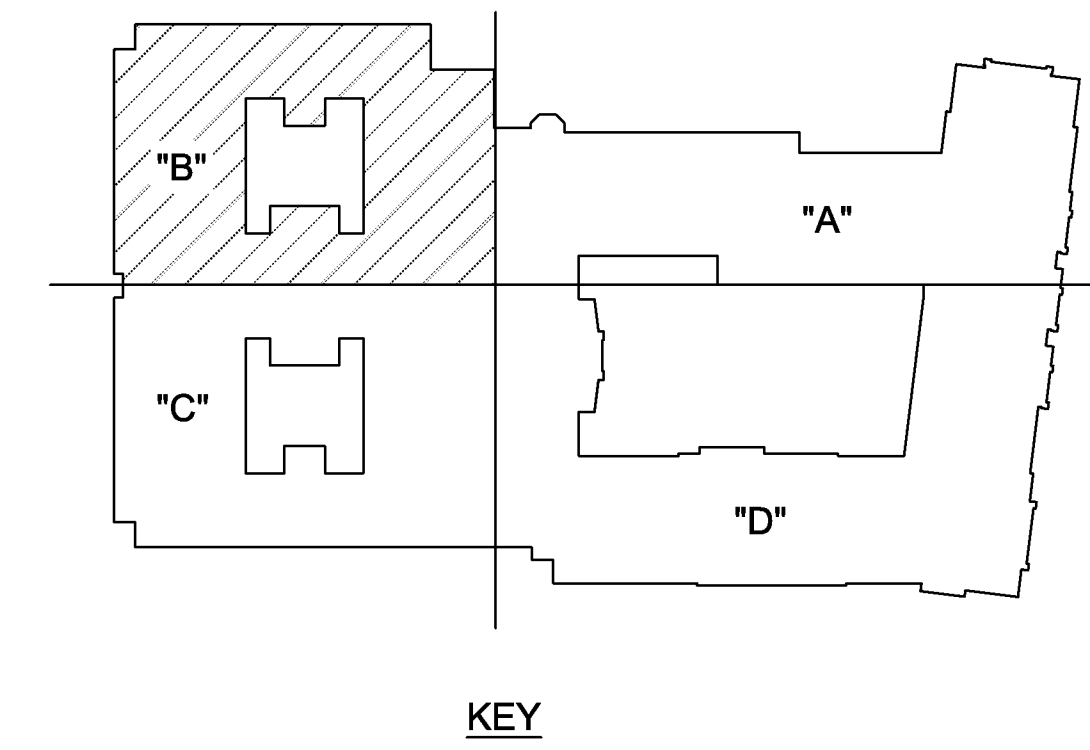
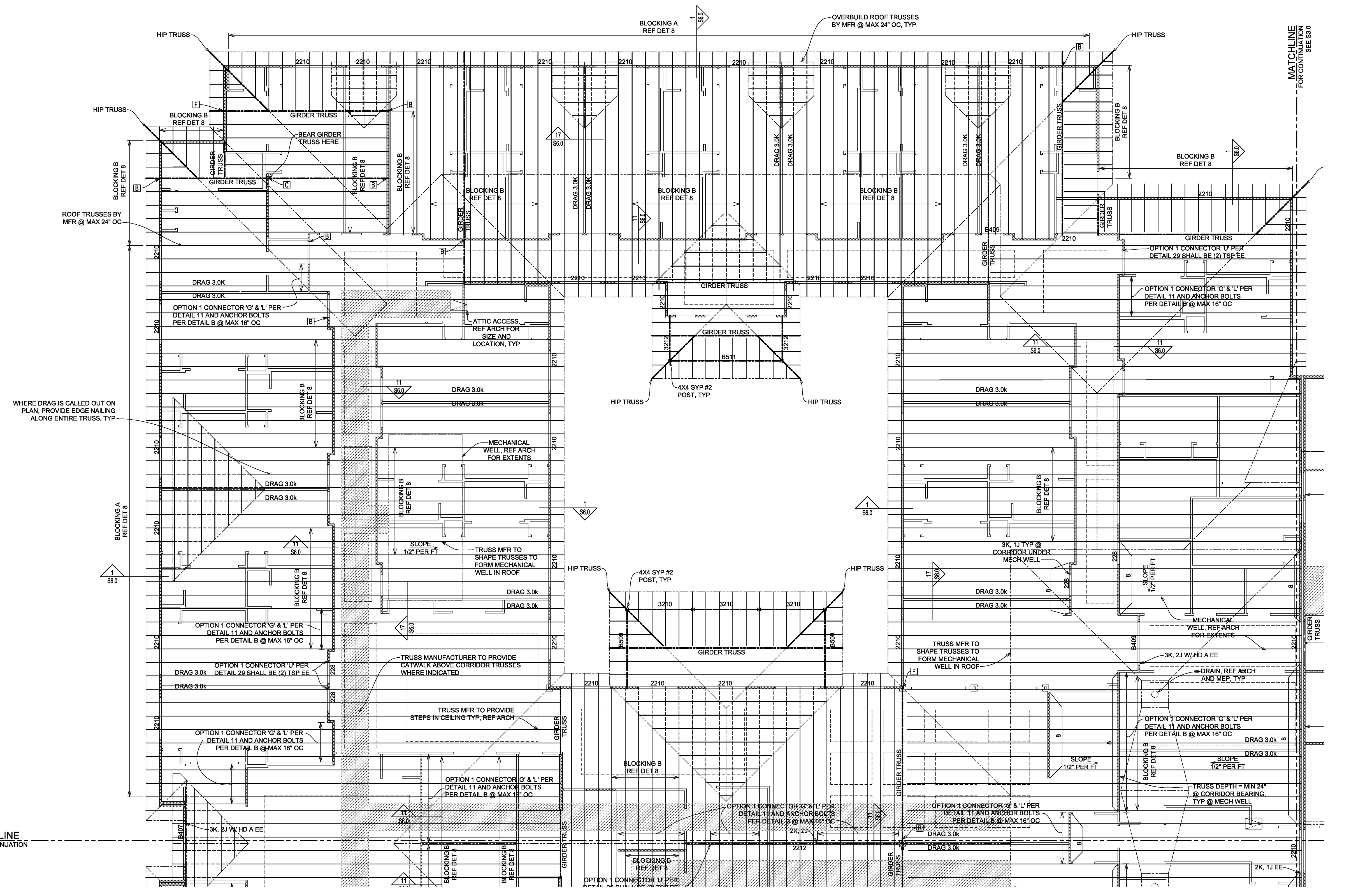

**AREA B
 ROOF FRAMING PLAN**
 1/8" = 1'-0"

TEXAS DESIGN INTERESTS, LLC
 AUSTIN • HOUSTON
 COMMERCIAL/RESIDENTIAL - CIVIL & STRUCTURAL ENGINEERING

6001 W. WILLIAM CANNON BUILDING 2, SUITE 203-C
 AUSTIN, TX 78749
 (512) 301-3389 (o)
 (512) 301-3348 (f)

TDI PROJECT #201-156