

- FOUNDATION PLAN NOTES**
1. VERIFY ALL DIMENSIONS, DROPS, SLOPES, ETC WITH ARCH PRIOR TO CONSTRUCTION.
 2. ALL ELEVATIONS ARE RELATIVE TO TOP OF CONC AT 1ST FLOOR + 100'-0".
 3. SLAB DEPTH SHALL BE MAINTAINED THROUGH ALL DROPS, SLOPES, ETC.
 4. GRADE BEAM WIDTH SHALL BE 18" MIN AND DEPTH SHALL BE 24" MIN.
 5. EXT FOOTINGS & GRADE BEAMS SHALL BEAR 18" MIN BELOW FINISHED GRADE.
 6. INCREASE DEPTH OF EXT FOOTINGS AND GRADE BEAMS AS REQUIRED TO MAINTAIN MIN EMBEDMENT INTO FIN GRADE.
 7. REF DETAIL C FOR ADDL REINF AT FOOTING AND WALL CORNERS.
 8. REF DETAIL G FOR ADDL REINF AT PLUMBING PENETRATIONS.
 9. REF DETAIL H FOR HOLDDOWN ANCHOR BOLTS.
 10. REF DETAIL H FOR HOLDDOWN ANCHOR BOLTS.
 11. ALL SLAB AREAS SHALL BE UNDERLAIN W/ 8" OF CLEAN SAND OR CLEAN GRAVEL.

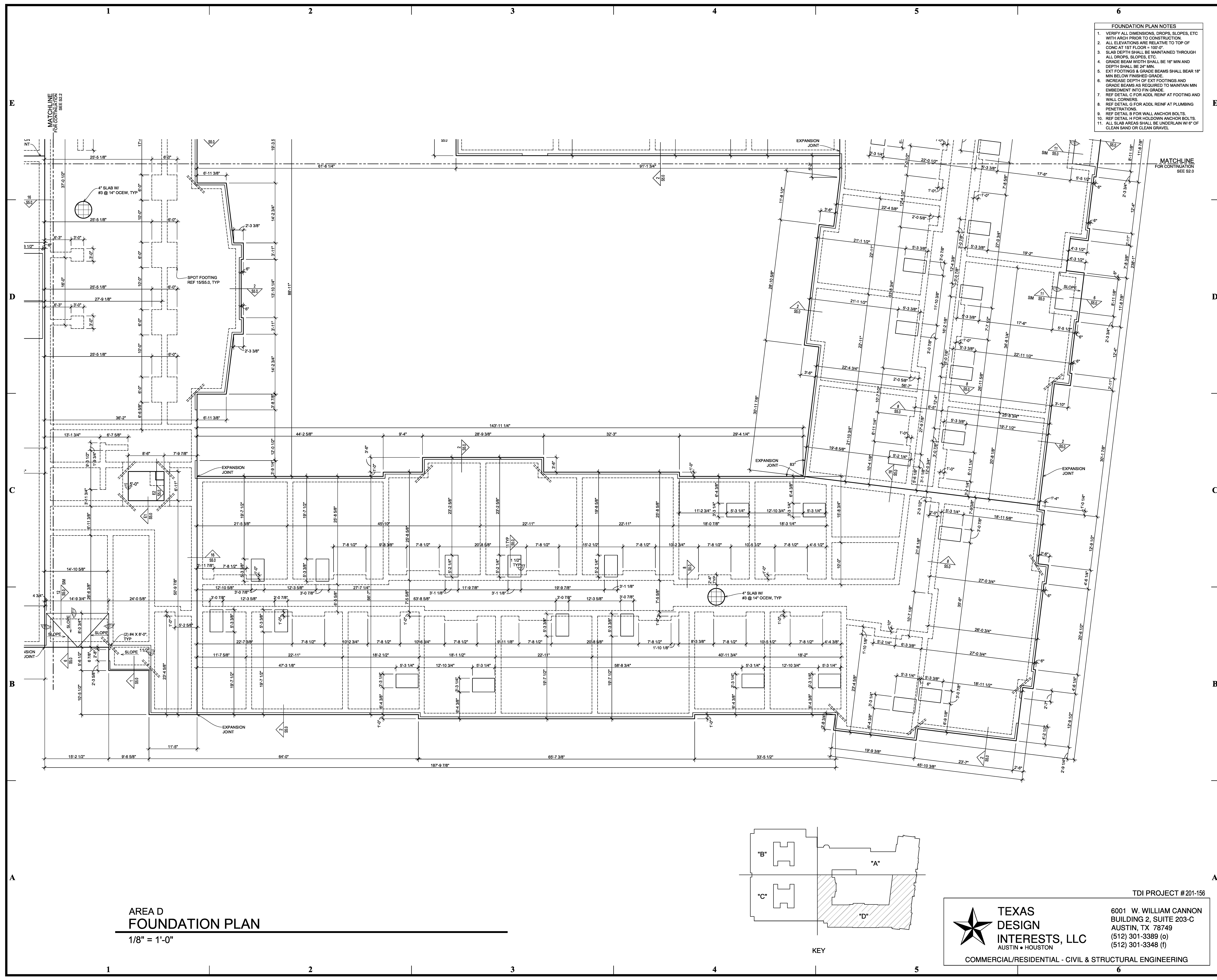

pi architects
3500 Jefferson St. Suite 303
Austin, TX 78731
P: (512) 231-1910
F: (512) 231-1950
www.piarch.com

architecture + master planning
interior + landscape
architecture

JEFFREY E. CLOUD
LICENSED PROFESSIONAL ENGINEER
FIRM REG. # 0597

WATERSTONE AT BATON ROUGE
ASSISTED LIVING & MEMORY CARE

SIEGEN LANE
BATON ROUGE, LA 70810

ISSUE:
PERMIT SET

©2015 PI ARCHITECTS, INC.

REVISIONS:

DATE:
3/31/2016
PROJECT NUMBER:
14017
SHEET TITLE:
FOUNDATION PLAN
SHEET:
S2.3