

**PLAN NOTES:**

1. HI AND CI FROM BELOW TO SERVE UNIT. REFER TO ENLARGED UNIT PLANS FOR LATER LAYOUT AND FITURE TAGS WITHIN UNITS.
2. HI AND CI FROM BELOW TO SERVE FITTURES.

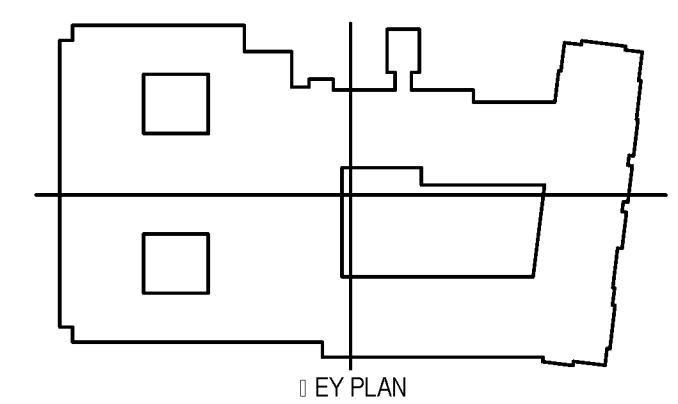

**1 | SECOND FLOOR PLUMBING LATER PLAN**  
 P2.2.1 1/8" = 1'-0"



**CONTRACTOR NOTE**  
 IT IS THE RESPONSIBILITY OF THE CONTRACTOR TO NOTIFY THE ARCHITECT, LANDLORD AND TENANT OF ANY DISCREPANCIES ENCOUNTERED ON THE PLANS OR IN EXISTING SITE CONDITIONS PRIOR TO SUBMISSION OF BID. BIDDERS ARE TO VISIT THE SITE AND FAMILIARIZE THEMSELVES WITH EXISTING CONDITIONS AND SATISFY THEMSELVES AS TO THE NATURE AND SCOPE OF THE WORK. THE BASE BID SHALL REFLECT MODIFICATIONS TO SYSTEMS AND DEVICES AS REQUIRED BY STATE, LOCAL AND FEDERAL CODES WHETHER INDICATED OR NOT ON CONTRACT DOCUMENTS. THE SUBMISSIONS OF A BID WILL BE EVIDENCE THAT SUCH AN EXAMINATION AND COMPLIANCE WITH GOVERNING CODES/REGULATIONS HAS BEEN MADE. LATER CLAIMS FOR LABOR, EQUIPMENT, OR MATERIALS REQUIRED, OR FOR DAMAGES ENCOUNTERED WHICH COULD HAVE BEEN FORESEEN HAD AN EXAMINATION AND CODES/REGULATIONS REVIEW BEEN MADE, WILL NOT BE ALLOWED.

BIM Server: Server\2012 - BIM Server\18 0\14017 Concordia Baton Rouge\18 001\Wednesday, September 02, 2015 14:04 PM