



REMSON|HALEY|HERPINARCHITECTS

Addendum No. One

Cypress River Lofts

1381, 1385, & 1389 Duane Street
Baton Rouge, LA 70802

RHHA Project No.: 75-01-17

July 17, 2018

This Addendum (consisting of 1 letter size pages, 1 24x36 drawing sheets) shall be attached to and shall become a part of the Contract Documents. The original Contract Documents shall be modified by this Addendum only to extent specifically stated herein.

CLARIFICATIONS / REVISIONS TO THE DRAWINGS:

1. Sheet A2.00:
 - a. Delete and replace A2.00 with the attached.

END OF ADDENDUM NO. ONE

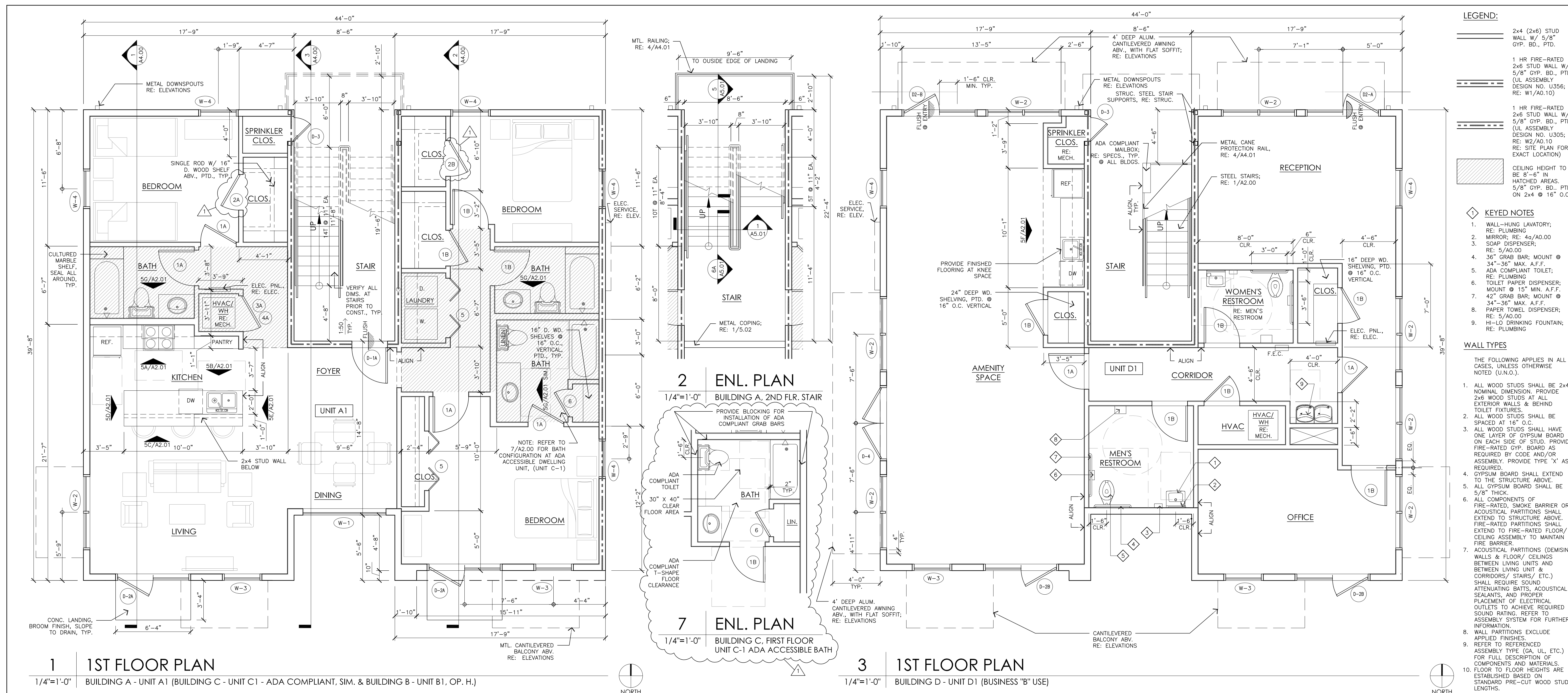

ROOM NAME	FLOOR	BASE	WALLS	CEILING	REMARKS
4 ROOM FINISH SCHEDULE					
FIRST FLOOR 3 BR UNIT (A1, B1, C1)					
FOYER	POLISHED CONC., SEALED	1X4 WD. BASE, PTD.	G.B., PTD.	G.B., PTD.	
KITCHEN	POLISHED CONC., SEALED	1X4 WD. BASE, PTD.	G.B., PTD.	G.B., PTD.	
DINING	POLISHED CONC., SEALED	1X4 WD. BASE, PTD.	G.B., PTD.	G.B., PTD.	
LIVING	POLISHED CONC., SEALED	1X4 WD. BASE, PTD.	G.B., PTD.	G.B., PTD.	
BATHROOM	CERAMIC TILE	1X4 WD. BASE, PTD.	G.B., PTD.	G.B., PTD.	
BEDROOM	POLISHED CONC., SEALED	1X4 WD. BASE, PTD.	G.B., PTD.	G.B., PTD.	
BEDROOM CLOSETS	POLISHED CONC., SEALED	1X4 WD. BASE, PTD.	G.B., PTD.	G.B., PTD.	
UTILITY CLOSET	POLISHED CONC., SEALED	1X4 WD. BASE, PTD.	G.B., PTD.	G.B., PTD.	
LAUNDRY	POLISHED CONC., SEALED	1X4 WD. BASE, PTD.	G.B., PTD.	G.B., PTD.	
LINEN CLOSET	POLISHED CONC., SEALED	1X4 WD. BASE, PTD.	G.B., PTD.	G.B., PTD.	
UPPER-LEVEL 1 BR UNIT (A2-A5, B2-B5, C2-C5, D2-D5)					
KITCHEN	EXP. LTWT. GYP. CEMENT, SEALED	1X4 WD. BASE, PTD.	G.B., PTD.	G.B., PTD.	
LIVING	EXP. LTWT. GYP. CEMENT, SEALED	1X4 WD. BASE, PTD.	G.B., PTD.	G.B., PTD.	
UTILITY CLOSET	EXP. LTWT. GYP. CEMENT, SEALED	1X4 WD. BASE, PTD.	G.B., PTD.	G.B., PTD.	
BATHROOM	CERAMIC TILE	1X4 WD. BASE, PTD.	G.B., PTD.	G.B., PTD.	
LAUNDRY CLOSET	EXP. LTWT. GYP. CEMENT, SEALED	1X4 WD. BASE, PTD.	G.B., PTD.	G.B., PTD.	
BEDROOM	EXP. LTWT. GYP. CEMENT, SEALED	1X4 WD. BASE, PTD.	G.B., PTD.	G.B., PTD.	
BEDROOM CLOSET	EXP. LTWT. GYP. CEMENT, SEALED	1X4 WD. BASE, PTD.	G.B., PTD.	G.B., PTD.	
GROUND LEVEL RETAIL UNIT (D1)					
RECEPTION	POLISHED CONC., SEALED	NONE	G.B., PTD.	G.B., PTD.	
CLOS.	POLISHED CONC., SEALED	NONE	G.B., PTD.	G.B., PTD.	
OFFICE	POLISHED CONC., SEALED	NONE	G.B., PTD.	G.B., PTD.	
CORRIDOR	POLISHED CONC., SEALED	NONE	G.B., PTD.	G.B., PTD.	
WOMEN'S RESTROOM	POLISHED CONC., SEALED	NONE	G.B., PTD.	G.B., PTD.	
MEN'S RESTROOM	POLISHED CONC., SEALED	NONE	G.B., PTD.	G.B., PTD.	
AMENITY SPACE	POLISHED CONC., SEALED	NONE	G.B., PTD.	G.B., PTD.	

ROOM NAME	FLOOR	BASE	WALLS	CEILING	REMARKS		
4 ROOM FINISH SCHEDULE (Continued)							
CLOS.	POLISHED CONC., SEALED	NONE	G.B., PTD.	G.B., PTD.			
HVAC	CONCRETE	NONE	G.B., PTD.	G.B., PTD.			
GENERAL UTILITIES SPACES							
SPRINKLER CLOSET	CONCRETE	NONE	G.B.	G.B.			
5 DOOR AND FRAME SCHEDULE							
NO.	FRAME OPENING WIDTH	FRAME OPENING HEIGHT	DOOR DESCRIPTION	FIRE LABEL	CLOSER	CASING	REMARKS
D-1A	3'-0"	6'-8"	1 3/4" INSULATED FIBERGLASS DOOR	1 HOUR	YES	1X4	SELF-CLOSING HINGES
D-1B	3'-0"	6'-8"	1 3/4" INSULATED FIBERGLASS DOOR	1 HOUR	YES	1X4	SELF-CLOSING HINGES
D-2A	6'-0"	6'-8"	(PAIR) 1 3/4" INSUL. FIBERGLASS DOOR W/ FULL LITE, W/ INSUL. GLAZING AND 2'-0" TRANSOM	N/A	NO	1X4	ONE ACTIVE LEAF/ ONE FIXED
D-2B	6'-0"	6'-8"	(PAIR) 1 3/4" INSUL. FIBERGLASS DOOR W/ FULL LITE, W/ INSUL. GLAZING AND 2'-0" TRANSOM	N/A	NO	1X4	ONE ACTIVE LEAF/ ONE FIXED
D-3	2'-0"	6'-8"	1 3/4" INSULATED FIBERGLASS DOOR	1 HOUR	YES	1X4	SELF-CLOSING HINGES
D-4	6'-0"	6'-8"	(PAIR) 1 3/4" INSUL. FIBERGLASS DOOR W/ FULL LITE, W/ INSUL. GLAZING AND 2'-0" TRANSOM	N/A	NO	1X4	
1A	3'-0"	6'-8"	1 3/8" FLUSH S.C. MASONITE DOOR, PTD.	N/A	NO	1X4	
1B	3'-0"	6'-8"	1 3/8" FLUSH S.C. MASONITE DOOR, PTD.	N/A	NO	1X4	
2A	3'-0"	6'-8"	1 3/8" FLUSH S.C. MASONITE DOOR, PTD.	N/A	NO	1X4	
2B	3'-0"	6'-8"	1 3/8" FLUSH S.C. MASONITE DOOR, PTD.	N/A	NO	1X4	
3A	3'-0"	2'-0"	1 3/8" FLUSH S.C. MASONITE DOOR, PTD.	N/A	NO	1X4	
3B	3'-0"	2'-0"	1 3/8" FLUSH S.C. MASONITE DOOR, PTD.	N/A	NO	1X4	
4A	3'-0"	4'-0"	1 3/8" FLUSH S.C. MASONITE DOOR, PTD.	N/A	NO	1X4	
4B	3'-0"	4'-0"	1 3/8" FLUSH S.C. MASONITE DOOR, PTD.	N/A	NO	1X4	
5	5'-0"	6'-8"	1 3/8" FLUSH S.C. MASONITE BI-FOLD DOOR, PTD.	N/A	NO	1X4	
6A	3'-0"	6'-8"	1 3/8" FLUSH S.C. MASONITE DOOR, PTD.	N/A	NO	1X4	
6B	3'-0"	6'-8"	1 3/8" FLUSH S.C. MASONITE DOOR, PTD.	N/A	NO	1X4	
NOTE: ALL EXTERIOR DOORS SHALL HAVE THRESHOLD AND WEATHER STRIPPING.							

NO.	FRAME OPENING WIDTH	FRAME OPENING HEIGHT	WINDOW DESCRIPTION	REMARKS
6 WINDOW SCHEDULE				
W-1	7'-0"	6'-8"	VINYL WINDOW, FIXED, W/ 3/4" INSUL. GLAZING AND 2'-0" TRANSOM	
W-2	6'-0"	6'-8"	VINYL WINDOW, FIXED, W/ 3/4" INSUL. GLAZING AND 2'-0" TRANSOM	
W-3	3'-0"	5'-0"	VINYL WINDOW, CASEMENT, W/ 3/4" INSUL. GLAZING AND 2'-0" TRANSOM	
W-4	3'-0"	5'-0"	VINYL WINDOW, CASEMENT, W/ 3/4" INSUL. GLAZING	
W-5	2'-0"	5'-0"	VINYL WINDOW, CASEMENT, W/ 3/4" INSUL. GLAZING	

1 ADDENDUM #1
REVISION DATE

7/17/18
DATE

Construction Documents
for
Cypress River Lofts

Oklahoma Street at Duane Street
Baton Rouge, Louisiana 70802

1ST FLOOR PLAN, BLDG. A & D
ENL. PLAN, BLDG. A 2ND FLR. STAIR
SCHEDULES

REMSON|HALEY|HERPIN ARCHITECTS

200 GOVERNMENT STREET | SUITE 100
BATON ROUGE, LOUISIANA 70802

© 2018 REMSON HALEY HERPIN ARCHITECTS
A PROFESSIONAL ARCHITECTURAL CORPORATION

7-13-2018
ISSUE DATE
75-01-17
PROJECT NO.

A2.00